

© Hulsey McCormick & Wallace, Inc., 2017. Design to agreement between Hulsey McCormick & Wallace, Inc. (HMC) and the party for which these documents have been prepared. These documents and all data, plans, specifications and other information contained herein are the sole and exclusive property of HMC, and may be used only in connection with the project for which these documents have been prepared by HMC, and for no other purpose. Any unauthorized use of these documents for any purpose shall be at the user's sole risk, without liability to HMC, and subject to reasonable compensation to be determined by HMC in its sole discretion. All rights of design and all rights reserved.

LEGEND

EXISTING	PROPOSED
BENCHMARK	⊕
BORE HOLE	⊙
PROPERTY LINE / RIGHT OF WAY	---
EASEMENT	---
100-YEAR FLOOD LIMITS	100YR
WETLANDS	---
CREEK / SWALE	---
FENCE	---
RAILROAD TRACK	---
GUARD RAIL	---
CONTOUR (MINOR)	---
CONTOUR (MAJOR)	---
SPOT ELEVATION	+
STORM SEWER PIPE	---
HEADWALL	---
DROP INLET/YARD INLET	---
JUNCTION BOX	---
END SECTION	---
CATCH BASIN	---
SANITARY SEWER MANHOLE	---
SANITARY SEWER LINE (GRAVITY)	---
SANITARY SEWER LINE (FORCEMAIN)	---
SANITARY SEWER CLEANOUT	---
WATER LINE	---
FIRE HYDRANT	---
WATER VALVE	---
WATER METER	---
WELL	---
GAS LINE	---
GAS VALVE	---
GAS METER	---
LIGHT POLE	---
POWER/UTILITY POLE/GUY WIRE	---
OVERHEAD POWER, TELEPHONE, & CABLE	---
UNDERGROUND POWER	---
UNDERGROUND TELEPHONE	---
TRANSFORMER	---
TELEPHONE BOX	---
CABLE BOX	---
TREE	---
ASPHALT PAVEMENT	---
CONCRETE PAVEMENT	---
CURB AND GUTTER	---
UNPAVED/GRAVEL ROAD	---
SILT FENCE	---
RIPRAP	---
SEDIMENT TUBE	---
INLET PROTECTION	---

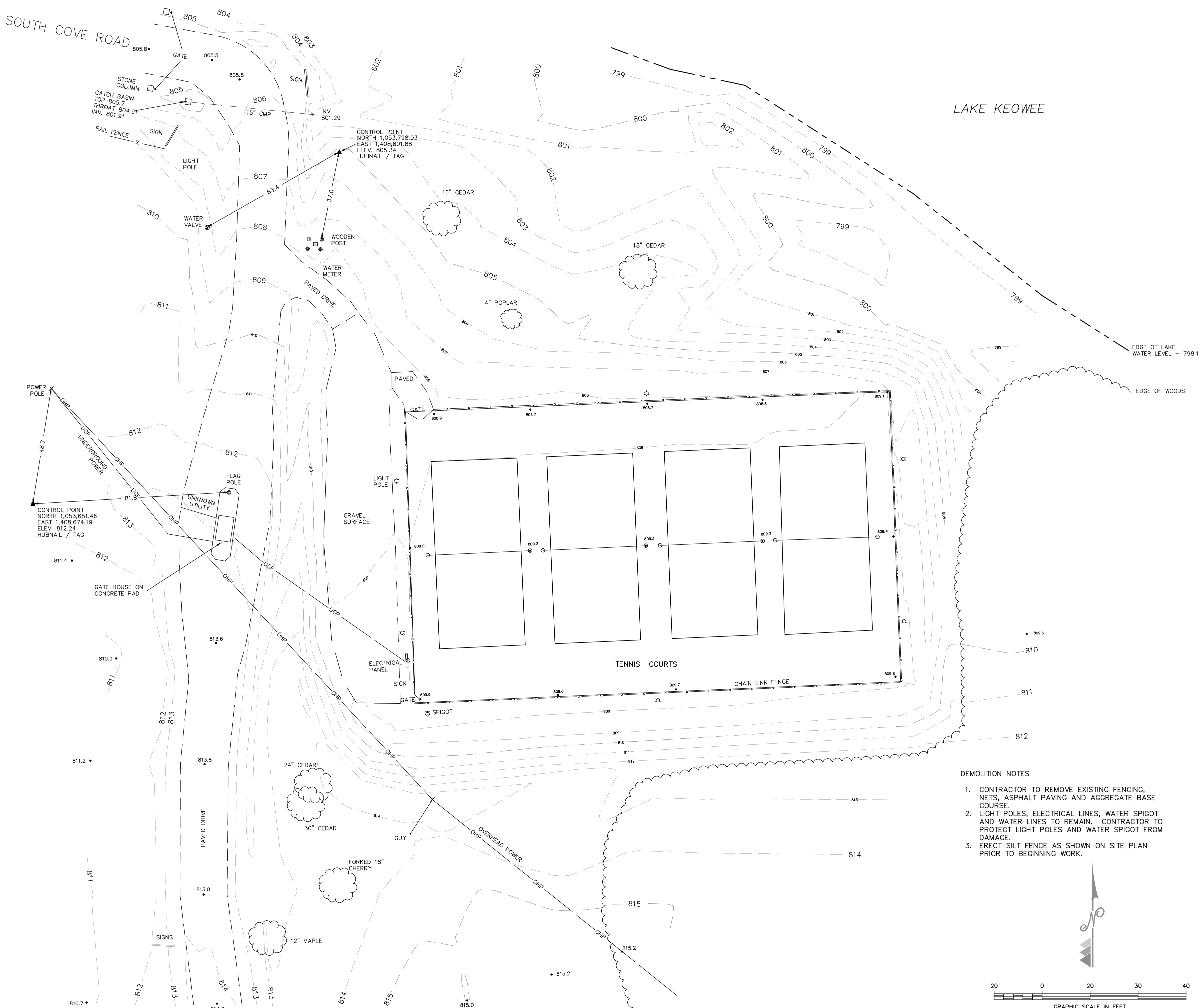

- DEMOLITION NOTES**
1. CONTRACTOR TO REMOVE EXISTING FENCING, NETS, ASPHALT PAVING AND AGGREGATE BASE COURSE.
 2. LIGHT POLES, ELECTRICAL LINES, WATER SPIGOT AND WATER LINES TO REMAIN. CONTRACTOR TO PROTECT LIGHT POLES AND WATER SPIGOT FROM DAMAGE.
 3. ERECT SILT FENCE AS SHOWN ON SITE PLAN PRIOR TO BEGINNING WORK.

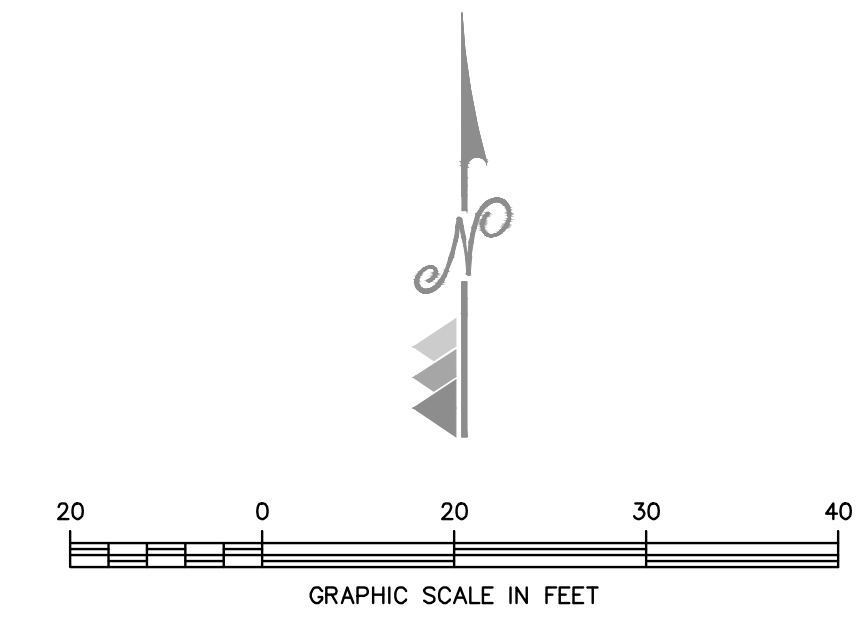

NO.	DATE	DESCRIPTION
A	01/26/18	FOR OWNER'S REVIEW
B	02/06/18	ISSUED FOR BIDS

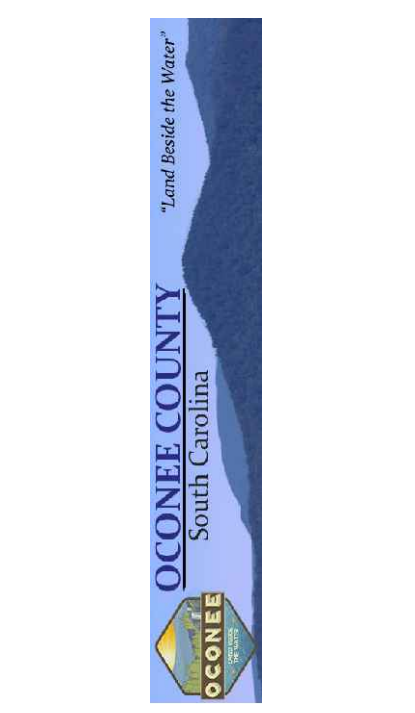

Hulsey McCormick & Wallace
 ENGINEERING • ENVIRONMENT • SCIENCE
 106 Clair Drive
 Piedmont, SC 29673-7771
 Phone: (864) 260-0800
 greenville@hulswengineering.com

EXISTING CONDITIONS/DEMOLITION PLAN
South Cove Park
Multi-Court Improvements
Oconee County Parks, Recreation & Tourism
 Seneca, South Carolina

PROJECT NO.:	OCO 001
DESIGNED:	HLM
CHECKED:	MRB
APPROVED:	HLM

C1.0

PRELIMINARY- NOT FOR CONSTRUCTION

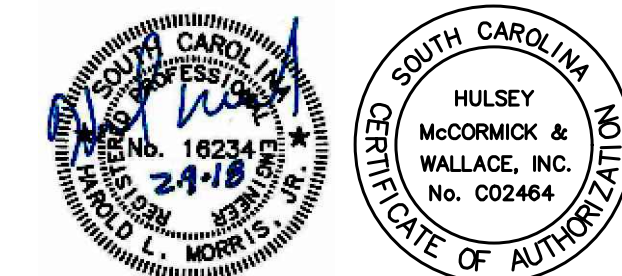

© Hulsey McCormick & Wallace, Inc. 2017. Present to agreement between Hulsey McCormick & Wallace, Inc. (HMC) and the City of Seneca, South Carolina. HMC and the City of Seneca, South Carolina, agree that the information contained herein is for informational purposes only and does not constitute a contract. HMC and the City of Seneca, South Carolina, agree that the information contained herein is for informational purposes only and does not constitute a contract. HMC and the City of Seneca, South Carolina, agree that the information contained herein is for informational purposes only and does not constitute a contract. HMC and the City of Seneca, South Carolina, agree that the information contained herein is for informational purposes only and does not constitute a contract.

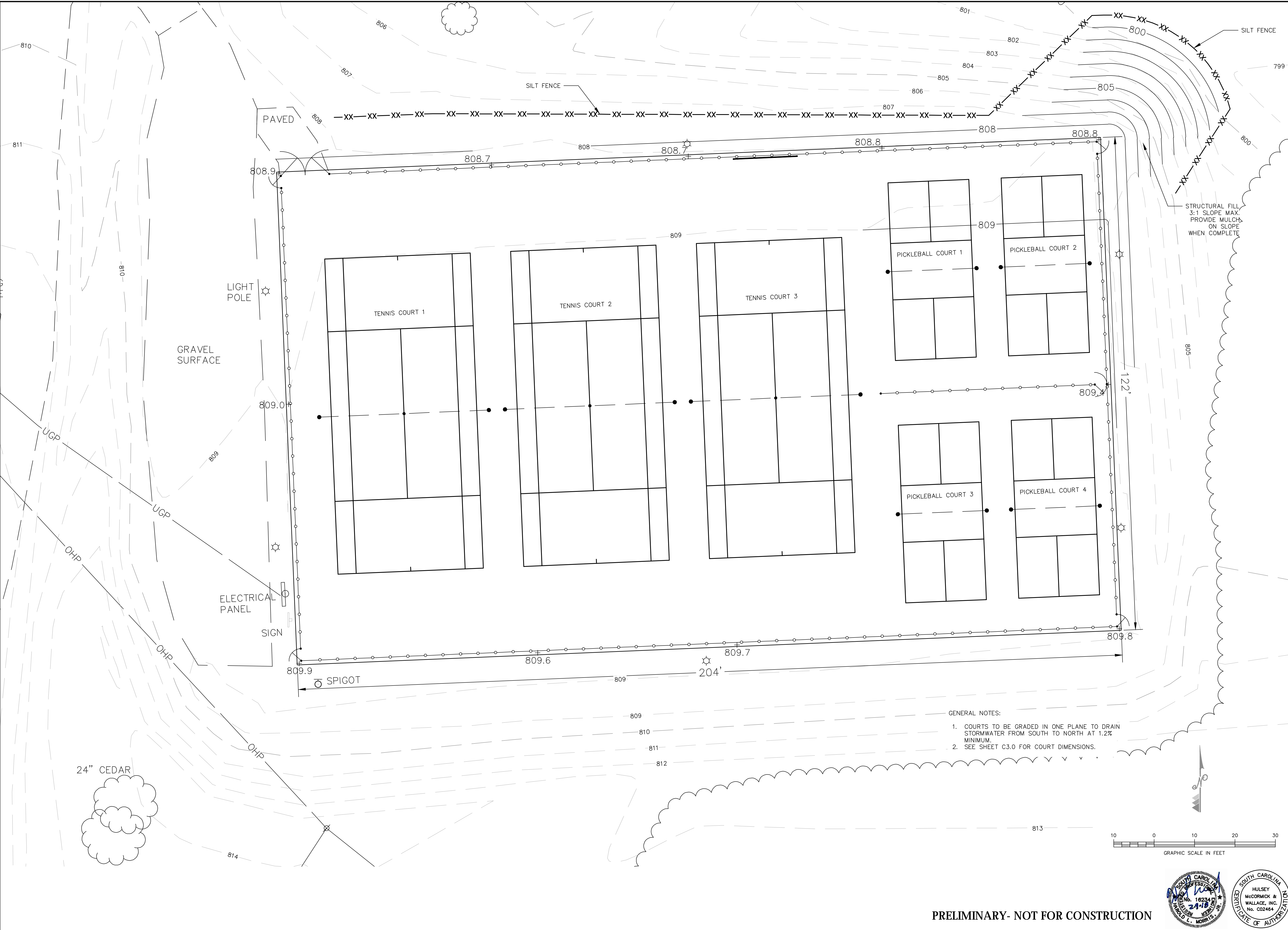

GENERAL NOTES:
 1. COURTS TO BE GRADED IN ONE PLANE TO DRAIN STORMWATER FROM SOUTH TO NORTH AT 1.2% MINIMUM.
 2. SEE SHEET C3.0 FOR COURT DIMENSIONS.

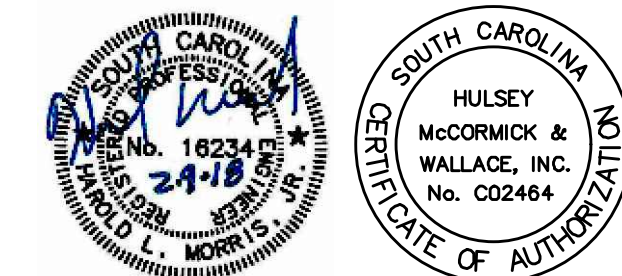

PRELIMINARY- NOT FOR CONSTRUCTION

ISSUE SEQUENCE	
NO.	DESCRIPTION FOR OWNER'S REVIEW ISSUED FOR BIDS
A	01/26/18
B	02/08/18

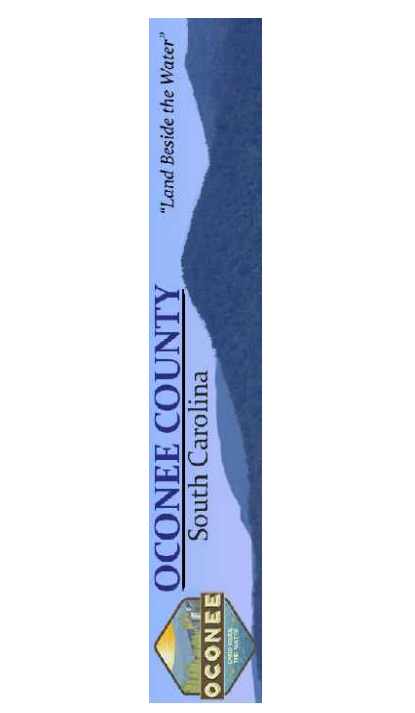

Hulsey McCormick & Wallace
 ENGINEERING • ENVIRONMENT • SCIENCE
 106 Clair Drive
 Piedmont, SC 29673-7771
 Phone: (864) 269-0890
 greenville@hulwengineers.com

SITE PLAN
 South Cove Park
 Multi-Court Improvements
 Oconee County Parks, Recreation & Tourism
 Seneca, South Carolina

PROJECT NO.:	OCO 001
DESIGNED:	HLM
CHECKED:	MRB
APPROVED:	HLM

C2.0

© Hulsey McCormick & Wallace, Inc., 2017. Document is prepared by Hulsey McCormick & Wallace, Inc. (HMC) and the user of this document shall be deemed to have accepted the user's responsibility for the use of this document. All rights of design and all rights reserved. This document is confidential and its disclosure to any other party without the written consent of HMC is prohibited.



- COURT CONSTRUCTION NOTES:**
1. THE GRADING FOR THE COURTS SHALL BE LASER GRADED. THE FINISHED PAVEMENT AND SURFACE TOLERANCES ARE A MAXIMUM OF 1/8" INCH IN 10 FEET.
 2. FENCE AND GATES: THE FENCE AND GATES ARE PVC COATED CHAIN LINK FABRIC ON PVC COLOR COATED GALVANIZED FRAMEWORK, COLOR BLACK. INSTALLED ON THE COURT SIDE OF THE FENCE STRUCTURE. ALL FENCE AND GATES TO HAVE WIND SCREEN INSTALLED ON THE COURT SIDE, SEE SPECIFICATIONS.
 3. COURT SURFACE: SEE SPECIFICATIONS FOR ASPHALT TENNIS COURT SURFACE COATING SYSTEM.
 4. THE COURTS ARE TO BE A TWO COLOR SYSTEM. PROVIDE STANDARD COLOR CHART FOR OWNERS SELECTION.

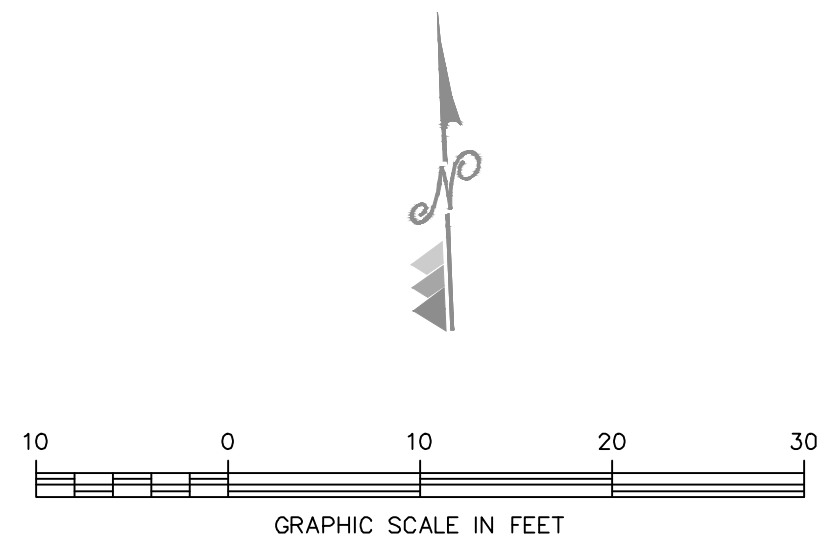
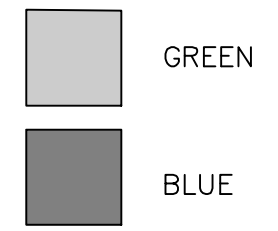

NO.	DATE	DESCRIPTION
A	01/26/18	FOR OWNER'S REVIEW
B	02/08/18	ISSUED FOR BIDS



Hulsey McCormick & Wallace
 ENGINEERING • ENVIRONMENT • SCIENCE
 106 Clair Drive
 Piedmont, SC 29673-7771
 Phone: (864) 269-0890
 greenville@hulwengineers.com

COURT LAYOUT PLAN
 South Cove Park
 Multi-Court Improvements
 Oconee County Parks, Recreation & Tourism
 Seneca, South Carolina

PROJECT NO.: OCO 001
 DESIGNED: HLM
 CHECKED: MRB
 APPROVED: HLM

C3.0

PRELIMINARY- NOT FOR CONSTRUCTION

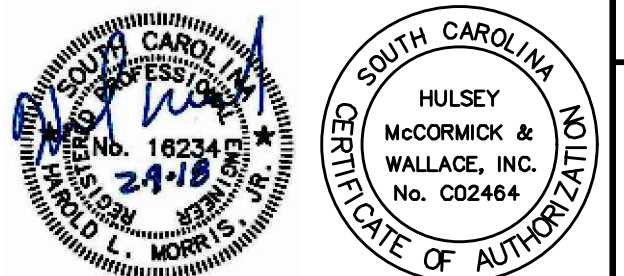

© Hulsey McCormick & Wallace, Inc. 2017. Document is prepared by Hulsey McCormick & Wallace, Inc. (HMCW) and the user for their use only. No part of this document may be reproduced, stored in a retrieval system, or transmitted in any form or by any means, electronic, mechanical, photocopying, recording, or by any information storage and retrieval system, without the prior written permission of Hulsey McCormick & Wallace, Inc. All rights reserved.

GRASSING NOTES

- USE ADEQUATE NUMBERS OF SKILLED WORKMEN WHO ARE THOROUGHLY TRAINED AND EXPERIENCED IN THE NECESSARY CRAFTS AND WHO ARE COMPLETELY FAMILIAR WITH THE SPECIFIED REQUIREMENTS AND THE METHODS NEEDED FOR PROPER PERFORMANCE OF THE WORK OF THIS SECTION.
- SEED CONFORM TO STATE LAWS AND TO ALL REQUIREMENTS AND REGULATIONS OF THE SOUTH CAROLINA DEPARTMENT OF AGRICULTURE. DELIVER TO SITE EACH VARIETY OF SEED INDIVIDUALLY PACKAGED AND TAGGED TO SHOW NAME, NET WEIGHT, ORIGIN AND LOT NUMBER.
- FERTILIZER: CONFORM TO STATE FERTILIZER LAW.
- AT TIME OF DELIVERY, FURNISH THE ENGINEER INVOICES OF ALL MATERIALS RECEIVED IN ORDER THAT APPLICATION RATES MAY BE DETERMINED. IMMEDIATELY REMOVE FROM THE SITE MATERIALS THAT DO NOT COMPLY WITH THE SPECIFIED REQUIREMENTS, AND PROMPTLY REPLACE WITH MATERIALS MEETING THE SPECIFIED REQUIREMENTS.
- PROVIDE A MIXED FERTILIZER WITH A DESIGNATION SUCH AS 10-10-10, WHERE THE FIRST NUMBER REPRESENTS THE MINIMUM PERCENT OF NITROGEN REQUIRED, THE SECOND NUMBER REPRESENTS THE MINIMUM PERCENT OF AVAILABLE PHOSPHORIC ACID REQUIRED, AND THE THIRD NUMBER REPRESENTS THE MINIMUM PERCENT OF WATER SOLUBLE POTASH REQUIRED IN THE FERTILIZER. FOR CENTIPEDE GRASS, USE ONLY 15-0-15 OR 16-4-8 FERTILIZER. FERTILIZER SHALL BE DELIVERED TO THE SITE IN BAGS LABELED WITH THE MANUFACTURER'S GUARANTEED ANALYSIS.
- PROVIDE GRASS SEED WHICH IS: FREE FROM NOXIOUS WEED SEEDS, AND CLEANED. GRADE A RECENT CROP. SEED, TREATED WITH APPROPRIATE FUNGICIDE AT THE TIME OF MIXING. DELIVERED TO THE SITE IN SEALED CONTAINERS WITH DEALER'S GUARANTEED ANALYSIS.
- LIME: PROVIDE AGRICULTURAL GRADE, STANDARD GROUND LIME STONE CONFORMING TO CURRENT RULES, REGULATIONS AND STANDARDS OF THE FERTILIZER BOARD OF CONTROL, ISSUED AT CLEMSON UNIVERSITY. BAG TAGS OR DELIVERY SLIP FOR BULK LOADS SHALL INDICATE BRAND OR TRADE NAME, CALCIUM CARBONATE EQUIVALENT, AND OTHER PERTINENT DATA TO IDENTIFY THE LIME.
- WOOD CELLULOSE FIBER: PROVIDE WOOD CHIP PARTICLES MANUFACTURED PARTICULARLY FOR DISCHARGING UNIFORMLY ON THE GROUND SURFACE WHEN DISPERSED BY A HYDRAULIC WATER SPRAYER. MATERIAL TO BE HEAT PROCESSED SO AS TO CONTAIN NO GERMINATION OR GROWTH INHIBITING FACTORS. IT SHALL BE DYED (NON-TOXIC) AN APPROPRIATE COLOR TO FACILITATE METERING.
- STRAW MULCH: PROVIDE STRAW OR HAY MATERIAL. STRAW TO BE STALKS OF WHEAT, RYE, BARLEY OR OATS. HAY TO BE TIMOTHY, PEAVINE, ALFALFA, OR COASTAL BERMUDA. MATERIAL TO BE REASONABLY DRY AND REASONABLY FREE FROM MATURE SEED BEARING STALKS, ROOTS OR BULLETS OR JOHNSON GRASS, NUTGRASS, WILD ONION, SANJERUB, WILD GARLIC, WILD MUSTARD, CROTOLARIA, PIGWEED, WITCHWEED, AND COCKLEBUR AND OTHER NOXIOUS WEEDS.
- EXCESSOR FIBER MULCH: TO CONSIST OF 4" TO 6" AVERAGE LENGTH, WOOD FIBERS CUT FROM SOUND, GREEN TIMBER, MAKE CUT IN SUCH A MANNER TO PROVIDE MAXIMUM STRENGTH OF FIBER, BUT AT A SLIGHT ANGLE TO NATURAL GRAIN OF THE WOOD.
- EROSION CONTROL BLANKET: PROVIDE ON AREAS AS SHOWN ON THE PLANS. PROVIDE EROSION CONTROL BLANKET S150, FROM NORTH AMERICAN GREEN, OR APPROVED EQUAL.
- SEED AREAS IMMEDIATELY UPON COMPLETION OF GRADING OR CONSTRUCTION AND CLEAN-UP OPERATIONS. SLOPES GREATER THAN FOUR HORIZONTAL TO ONE VERTICAL. UTILITY RIGHTS-OF-WAY ADJACENT TO STREAM BANKS.
- SEEDING SCHEDULES: UNLESS OTHERWISE PROVIDED, SELECT THE TYPE OF SEEDING FROM THE TABLES SHOWN BELOW FOR THE UPPER STATE REGION AS APPLICABLE TO THE PROJECT. THE TOTAL SEED RATE IN POUNDS PER ACRE IS THE SUM TOTAL SHOWN FOR ALL THE VARIETIES OF SEED OPPOSITE THE SCHEDULE NUMBER IN THE SEEDING SCHEDULES INCLUDED HEREIN. THE UPPER STATE REGION CONSISTS OF ALL COUNTIES WEST OF THE COUNTIES OF AKEN, LEXINGTON, RICHLAND, Kershaw, AND CHESTERFIELD. THE LOWER STATE REGION CONSISTS OF THE ABOVE-CITED COUNTIES AND ALL COUNTIES EAST.

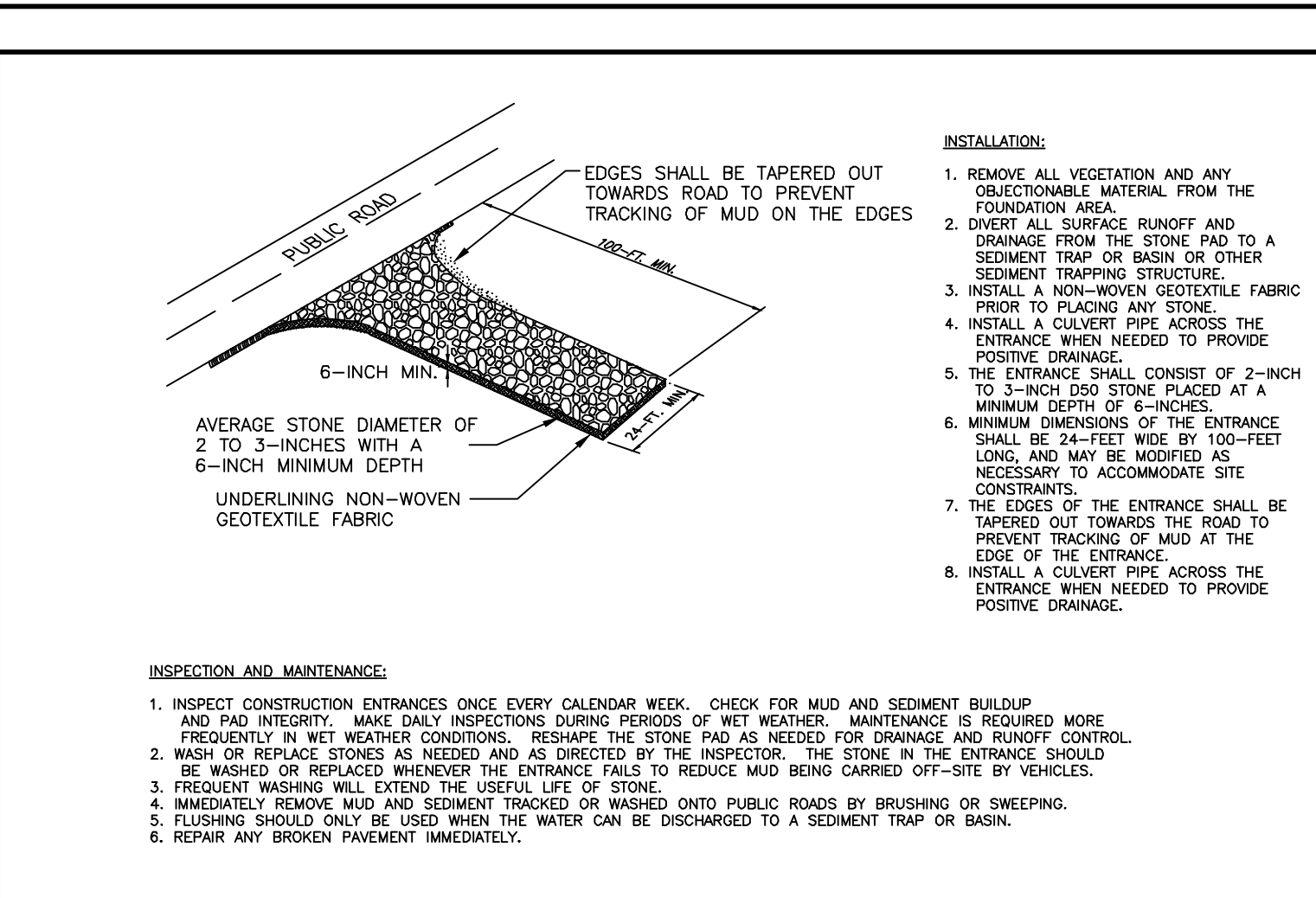
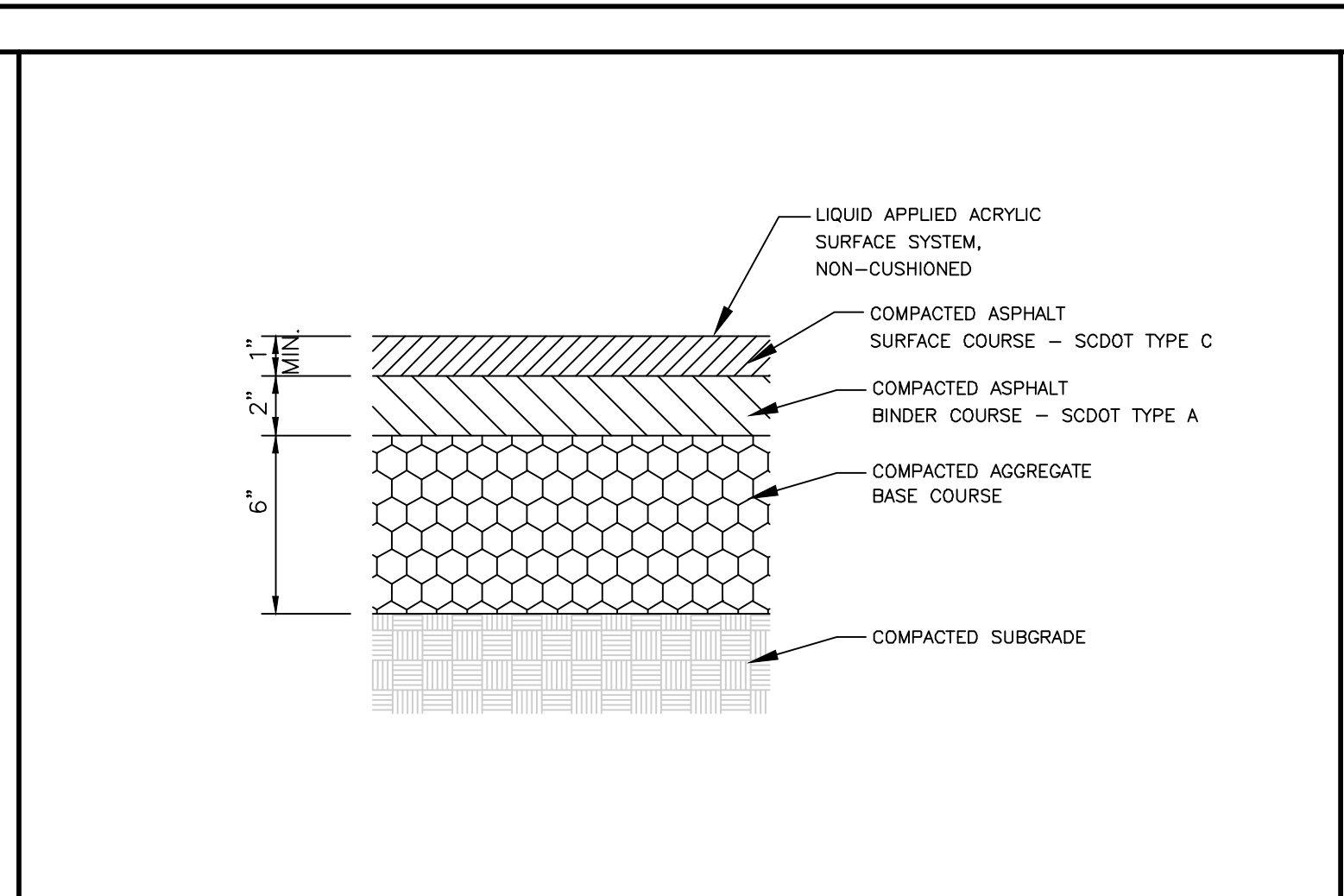
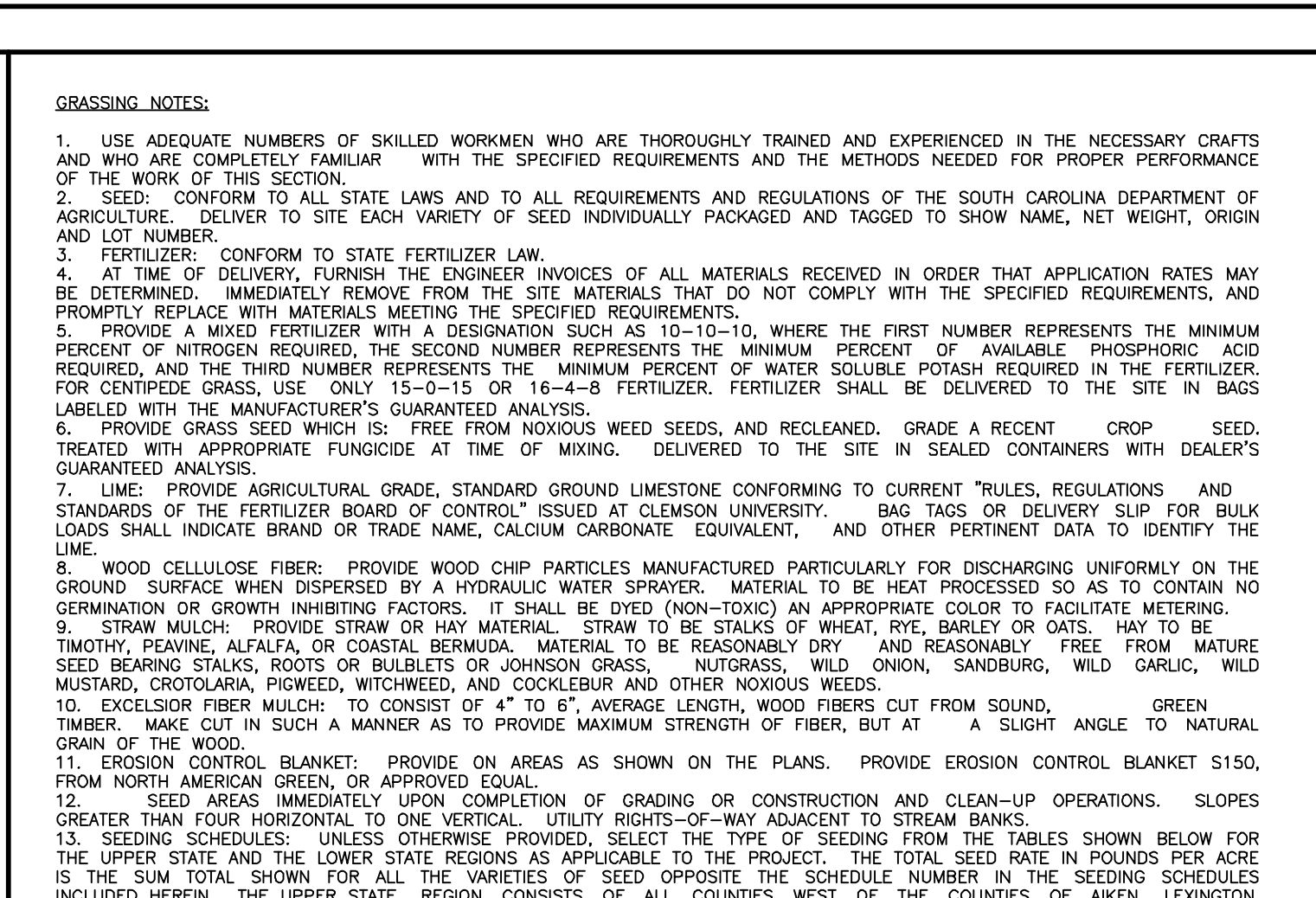

NO.	SEED	SEED RATE (LBS. PER ACRE)	SEEDING PERIOD
1	COMMON BERMUDA(HULLED) 3	23	MARCH 15 TO AUGUST 14
	SERICEA LESPEDEZA(SCARIFIED) 2	50	
	KENTUCKY 31 FESCUE WEEPING LOVEGRASS 2	10	
2	KENTUCKY 31 FESCUE SERICEA LESPEDEZA(UNHULLED, UNSCARIFIED) 2	80	AUGUST 15 TO MARCH 14
	COMMON BERMUDA(UNHULLED) 3	30	
	WEEPING LOVEGRASS 2	10	
3	COMMON BERMUDA(HULLED) 3	30	MARCH 1 TO AUGUST 14
	WEEPING LOVEGRASS 2	10	
	WEEPING LOVEGRASS 2	10	
4	COMMON BERMUDA(UNHULLED) 3	40	AUGUST 15 TO FEBRUARY 28
	WEEPING LOVEGRASS 2	10	
	SERICEA LESPEDEZA(UNHULLED, UNSCARIFIED) 2	80	
5	RESEEDING CRIMSON CLOVER 4	20	MARCH 1 TO APRIL 15
	ANNUAL RYE GRASS 5	5	
	RYE GRAIN	20	

NOTES:

- INCLUDES RURAL AREAS ADJACENT TO WELL-DEVELOPED LAWNS.
- NOT REQUIRED ON SHOULDERS, MEDIANS, ETC. AND ON SLOPES UNDER 5 FEET IN HEIGHT.
- DO NOT USE GIANT BERMUDA SEED INCLUDING NK-37.
- PROVIDE AN INOCULANT FOR TREATING RESEEDING CRIMSON CLOVER SEED OF A PURE CULTURE OF NITROGEN-FIXING BACTERIA SELECTED FOR A MAXIMUM VITALITY AND ABILITY TO TRANSFORM NITROGEN FROM THE AIR INTO SOLUBLE NITRATES AND DEPOSIT THEM INTO THE SOIL. ENSURE THAT INOCULANTS CONSIST OF PUREBRED CULTURES AND ARE NOT MORE THAN ONE YEAR OLD. DO NOT PLANT CLOVER IN MEDIANS OR IN RURAL AREAS ADJACENT TO WELL-DEVELOPED LAWNS.
- PENSACOLA BAHIA IS ALLOWED ONLY AS SHOWN IN SEEDING SCHEDULES 3 AND 4 AT THE RATE OF 50 POUNDS PER ACRE ONLY WHEN SEEDING PIT AREAS THAT ARE GOVERNED BY THE SOUTH CAROLINA MINING ACT. OTHERWISE, DO NOT INCLUDE BAHIA SEED IN THE MIX.
- APPLY ONE-HALF OF LIME RATES AND ONE-HALF OF MAINTENANCE FERTILIZER RATES. FERTILIZE CENTIPEDE AT THE APPLICATION RATE OF 20 POUNDS PER ACRE OF 16-4-8 OR 15-0-15.
- FERTILIZERS IN MAY AND REPEAT IN AUGUST.
- THE USE OF ITALIAN RYE GRASS IS PROHIBITED.

THE CONTRACTOR MAY INCLUDE QUANTITIES OF RYE GRASS AND MILLET IN SCHEDULE NOS. 1 AND 3 TO ESTABLISH QUICK GROUND COVER FOR EROSION CONTROL PURPOSES.

NO.	SEED	SEED RATE (LBS. PER ACRE)	SEEDING PERIOD
1	BROWN TOP MILLET	50	APRIL 1 TO AUGUST 15
2	RYE GRASS ANNUAL RYE GRASS	55	AUGUST 16 TO MARCH 31

1 THE USE OF ITALIAN RYE GRASS IS PROHIBITED.

GROUND PREPARATION:

- BRING ALL AREAS TO PROPER LINE, GRADE AND CROSS SECTION INDICATED ON THE PLANS.
- REPAIR EROSION DAMAGE PRIOR TO COMMENCING SEEDING OPERATIONS.
- LOOSEN SEEDBED TO MINIMUM DEPTH OF 3".
- REMOVE ALL ROOTS, CLODS, STONES LARGER THAN 1" IN ANY DIMENSION, AND OTHER DEBRIS.
- PROVIDE AND PREPARE TOPSOIL.
- CONDUCT SOIL TEST TO DETERMINE PH FACTOR. IF PH IS NOT IN THE RANGE OF 6.0 TO 6.5, ADJUST.

APPLICATION OF FERTILIZER:

- SPREAD UNIFORM OVER AREAS TO BE SEED AT: RATE OF 1000 LBS. PER ACRE.
- FERTILIZE CENTIPEDE AT THE APPLICATION RATE OF 20 POUNDS PER ACRE OF 16-4-8 OR 15-0-15.
- USE APPROX. A MECHANICAL SPREADER AS APPLICABLE TO THE PROJECT.
- MIX WITH SOIL TO DEPTH OF APPROXIMATELY 3".

SOWING METHODS

- PERFORM SEEDING DURING THE PERIODS AND AT THE RATES SPECIFIED IN THE SEEDING SCHEDULES.
- DO NOT CONDUCT SEEDING WORK WHEN GROUND IS FROZEN OR EXCESSIVELY WET.
- PRODUCE SATISFACTORY STAND OF GRASS REGARDLESS OF PERIOD OF THE YEAR THE WORK IS PERFORMED.
- SEEDING, SLOPES LESS THAN FOUR HORIZONTAL TO ONE VERTICAL.
- SHALL CONFORM TO METHODS EA, WF OR WCF AS SPECIFIED.

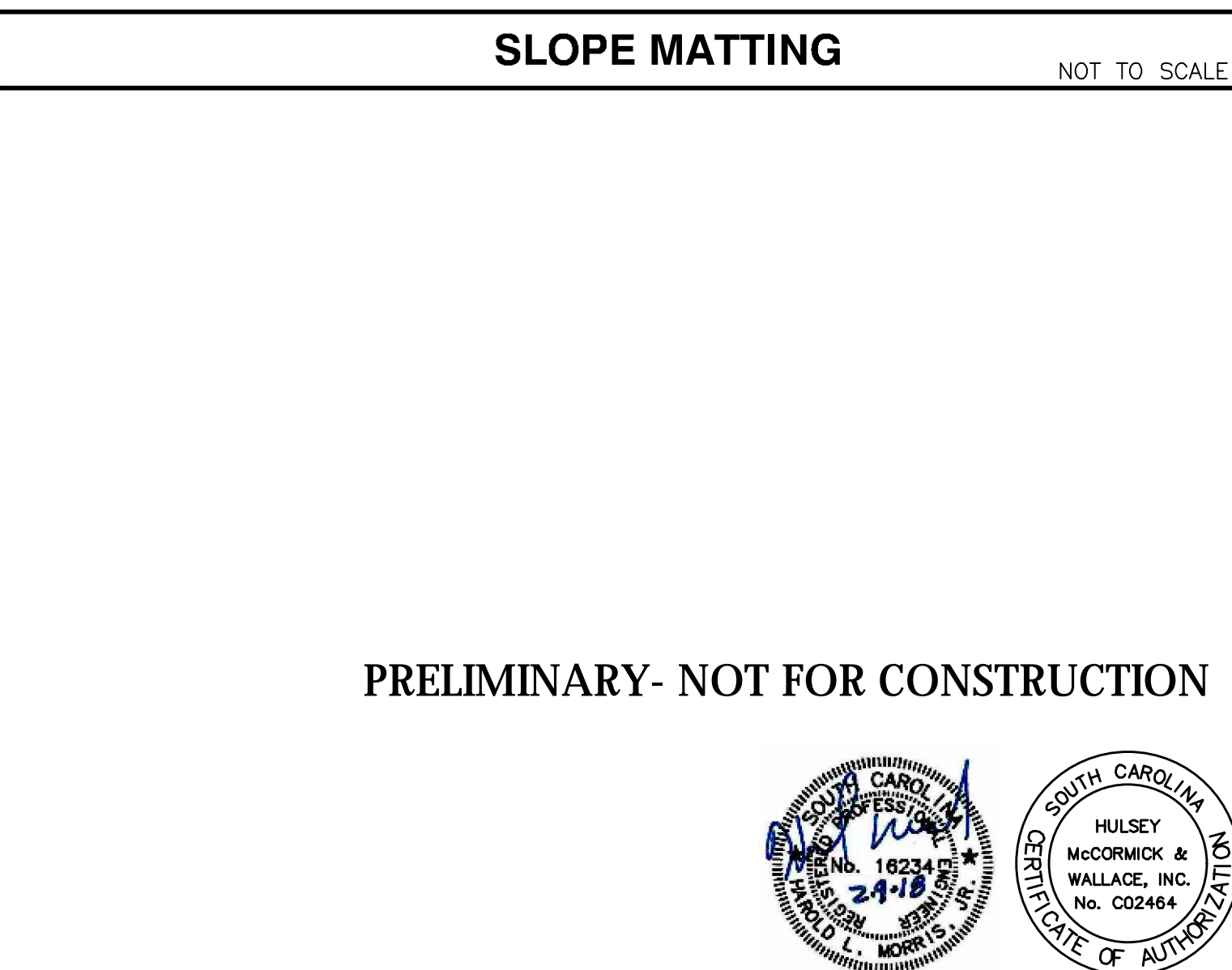
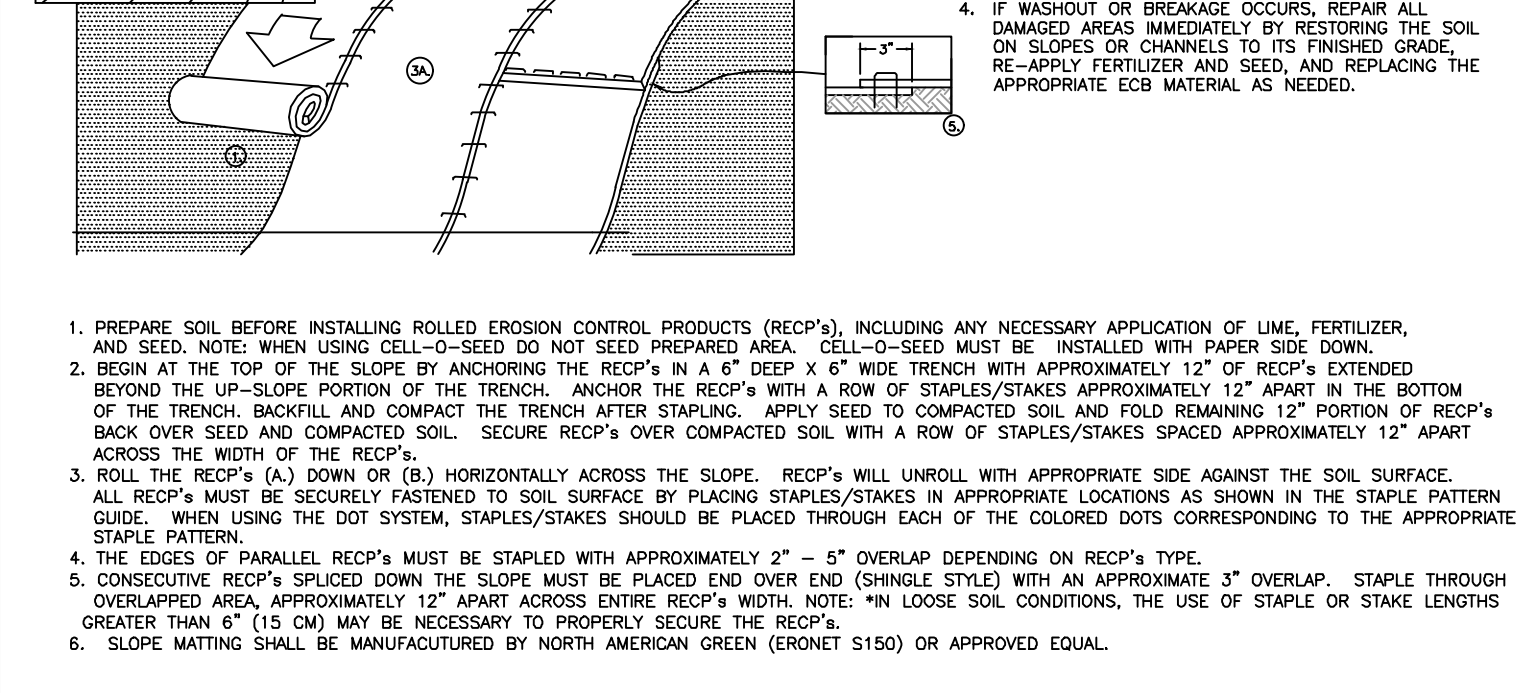
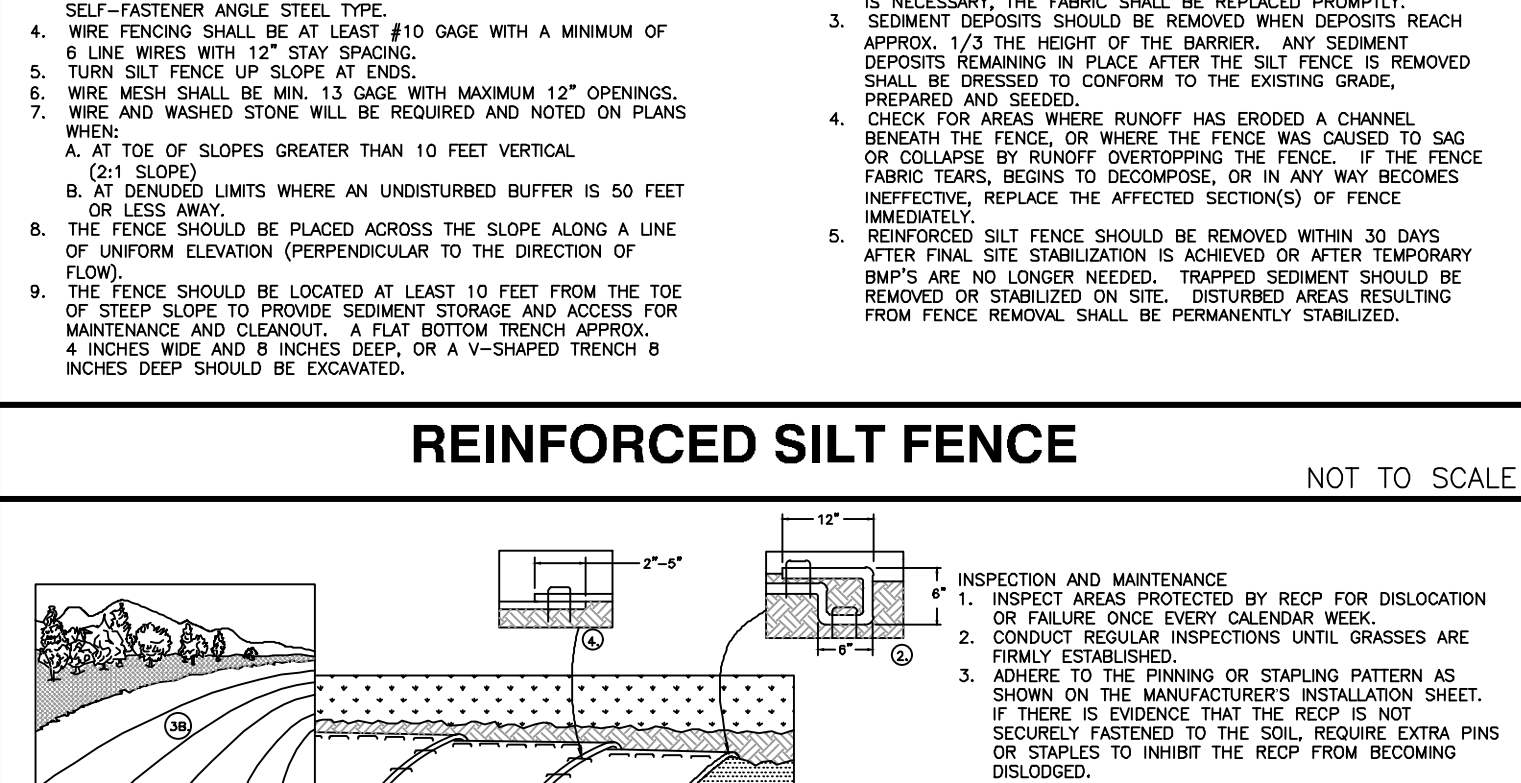
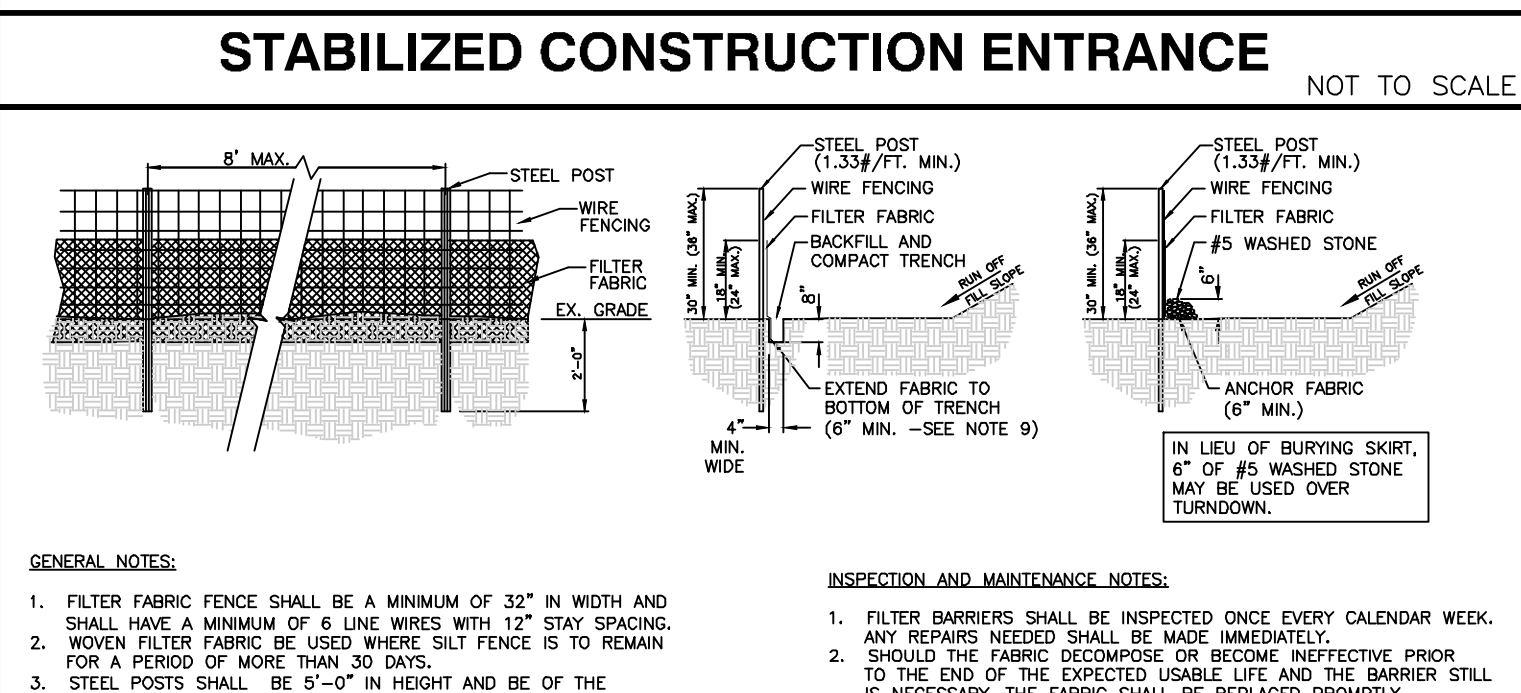
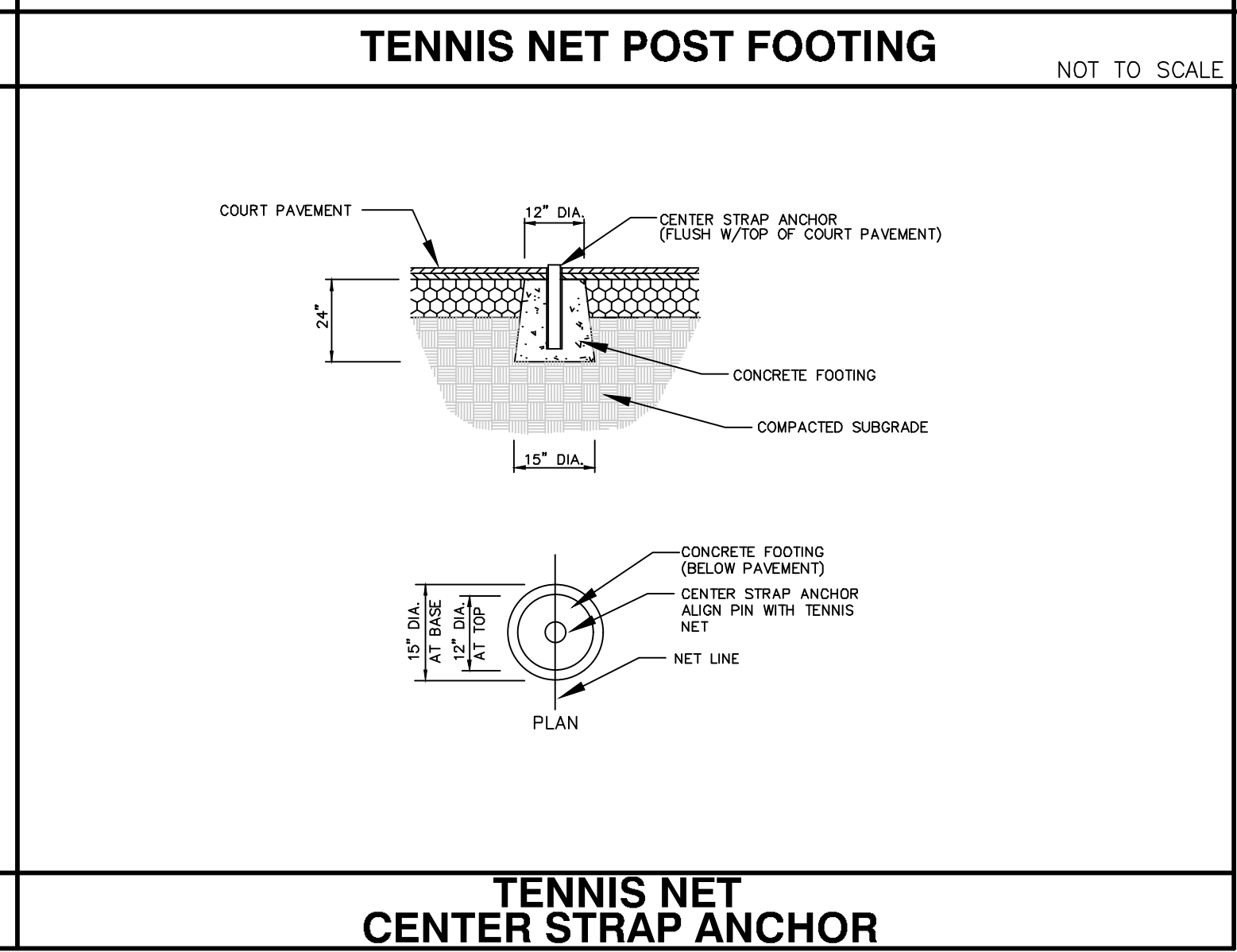
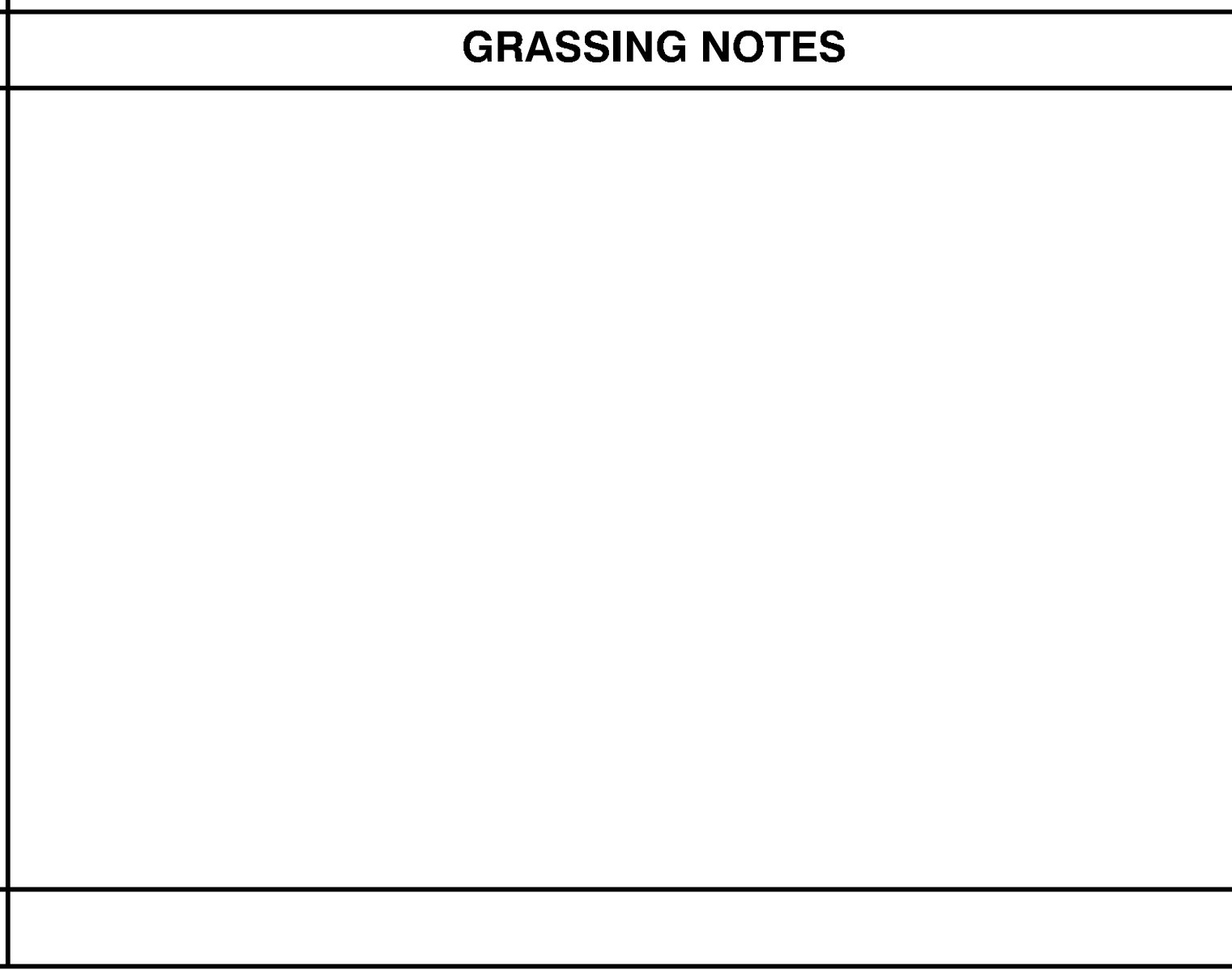

NO.	DATE	DESCRIPTION	FOR OWNER'S REVIEW	ISSUED FOR BIDS
A	01/28/18			
B	02/08/18			

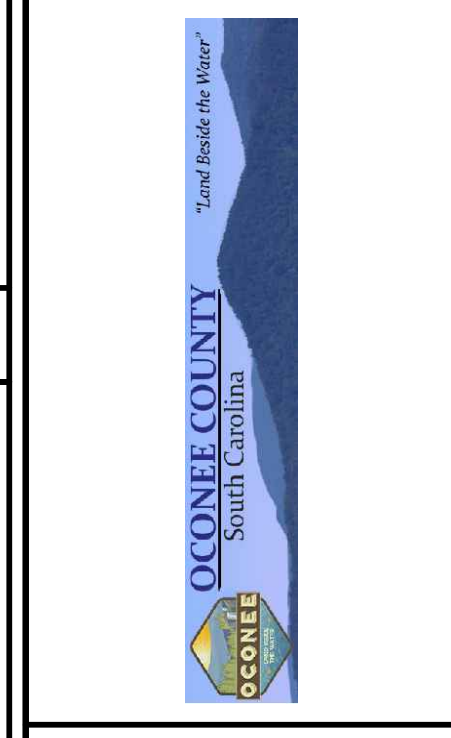

Hulsey McCormick & Wallace
 ENGINEERING - ENVIRONMENT - SCIENCE
 106 Clair Drive
 Piedmont, SC 29673-7771
 Phone: (864) 269-0890
 greenville@hulseywallace.com

DETAILS / SPECIFICATIONS
 South Cove Park
 Multi-Court Improvements
 Oconee County Parks, Recreation & Tourism
 Seneca, South Carolina

PROJECT NO.: OCO 001
 DESIGNED: HLM
 CHECKED: MRB
 APPROVED: HLM

C4.0

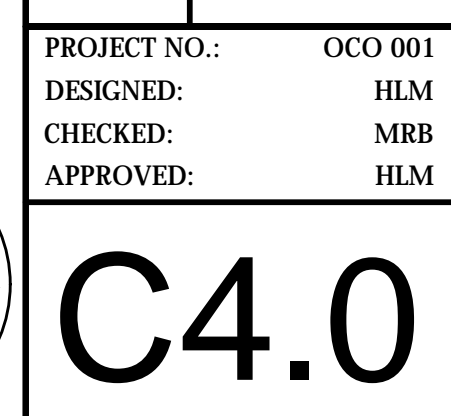

PRELIMINARY- NOT FOR CONSTRUCTION